

# Headset Mounted Basket w/Front Struts Installation Instructions

*Electra*



# Headset Mounted Basket w/Front Struts Installation Instructions

*Electra*

Designed to fit most 700c, 27.5" & 26" bicycle forks with eyelets. Not intended for mounting to the hub axle. Will not work on bicycles equipped with a suspension fork.

If you are not comfortable installing basket, please have it professionally installed by your Electra dealer.



## Tools need to install

- 8mm open end or box wrench  
(or small adjustable wrench)
- 32mm open-end wrench - for bikes with  
1" headsets (or large adjustable wrench)
- 36mm open-end wrench - for bikes with  
1 1/8" headsets (or large adjustable wrench)
- 3mm hex head wrench
- 4mm hex head wrench
- 6mm hex head wrench



## Included items:

- (1) headset mounted basket
- (1) adjustable steel front fork
- (1) steel plate buckle w/ ridge (3cm x 4.5cm)
- (2) nylon lock nuts
- (2) 15mm long 3mm hex head machine screws
- (2) 3mm hex head machine screws w/washers,  
20mm long
- (8) steel washers
- (1) steel inner plate (7cm wide x 1.5cm tall)
- (1) headset bracket for  
1" headset-equipped bikes
- (1) headset bracket for  
1 1/8" headset-equipped bikes
- (2) 12mm long 4mm hex head machine screws

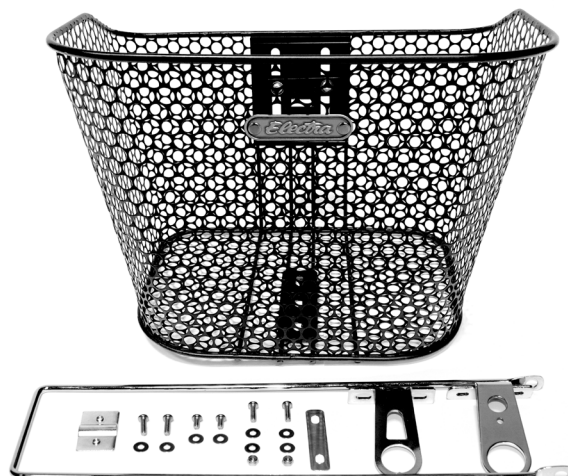

# Headset Mounted Basket w/Front Struts Installation Instructions

*Electra*

## To install

### STEP 1: Installation of fork strut to basket

- 1) Mount strut legs to bottom of basket with two 20mm hex head screws and the steel plate buckle.
- 2) Place bracket in forward position for most cruiser models, in rearward position for most Townie and Amsterdam models.
- 3) Tighten screws using 3mm hex head wrench.  
**DO NOT OVERTIGHTEN.**

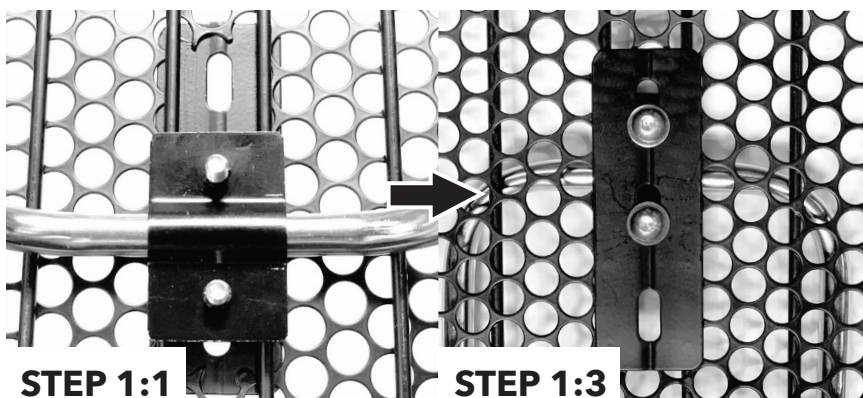

### STEP 2: Installation of headset bracket

- 1) Remove stem/handlebar combination using a 6mm hex wrench.
- 2) Remove top nut using 32, 36mm or adjustable wrench and put aside.
- 3) Remove steel key washer.
- 4) Install mounting bracket in place of key washer, lip side faces up.
- 5) Reinstall top nut using 32, 36mm or adjustable wrench.
- 6) Reinstall stem/handlebar combination using a 6mm hex wrench.



Note: Most Electra Cruiser models use 1" headsets while Townie models use 1 1/8" headsets. If mounting to a late-model Townie, it is necessary to remove the conical headset spacer. Put spacer aside for future use if basket is no longer installed. If you are unsure of the size of your headset, contact your local Electra dealer.



# Headset Mounted Basket w/Front Struts Installation Instructions

*Electra*

## STEP 3: Attaching basket to headset bracket

- 1) Thread 15mm long machine screws through steel washers and inner plate.
- 2) Thread 15mm long machine screws into headset bracket and additional washers.
- 3) Install nylon lock nuts, tighten.

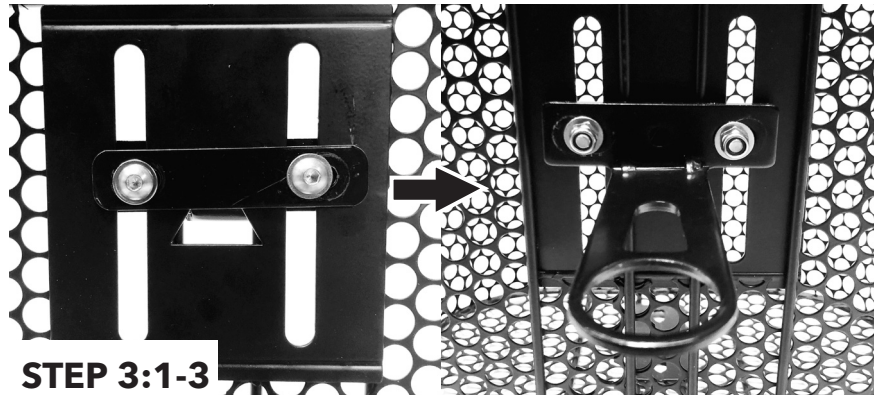

## STEP 4: Adjusting the strut lengths

- 1) Lengthen the strut to the desired length by twisting the lower rod anti-clockwise.
- 2) Once desired length is reached, twist the bolt clockwise until it is flush with the top part of the strut.

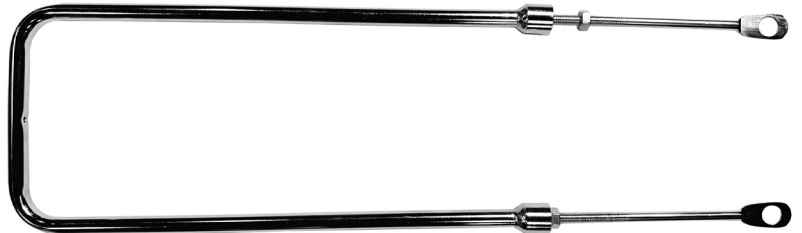

## STEP 4:1-2

## STEP 5: Attaching fork strut to fork eyelets

- 1) Remove any existing bolts that may be supporting fender stays (front/upper stay only).
- 2) Using the included hex head bolts with washers, mount the fork strut to the upper/front eyelets.
- 3) Reinstall any existing fender stays.



If you have questions regarding assembly, please visit your local Electra dealer or call Electra Customer Service at 800-261-1644 (8AM - 4PM Pacific Time).