

TREK



Slash Alloy and Carbon — Gen 6

SERVICE MANUAL

Rev 1 November 2023

Contents



[Safety](#)

Headset

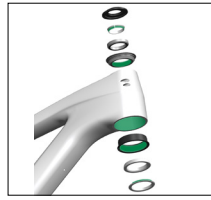

[Adjustable headset](#)

Idler pulley



[Idler pulley](#)

Linkage

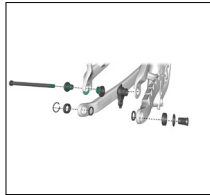

[Active Braking Pivot with Universal Derailleur Hanger](#)

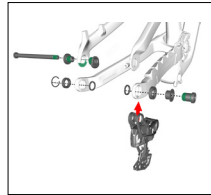

[Active Braking Pivot with SRAM Transmission Derailleur](#)

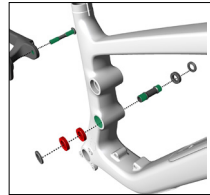

[Main pivot and chainstay](#)

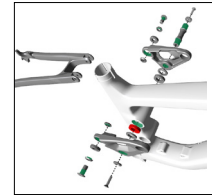

[Rocker pivot and seatstay](#)

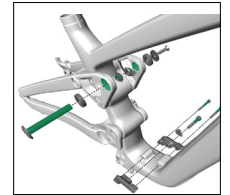

[Rear shock hardware](#)

Routing

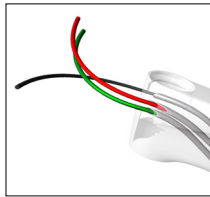

[Carbon routing with mechanical shift](#)

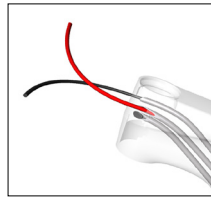

[Carbon routing with AXS shift](#)

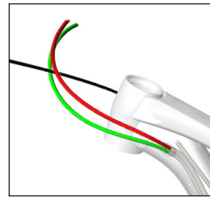

[Alloy routing with mechanical shift](#)

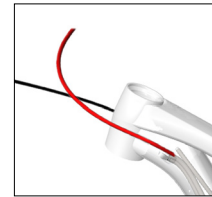

[Alloy routing with AXS shift](#)

Guards Rear fender Storage

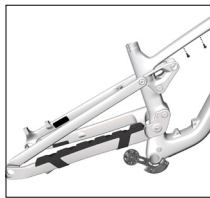

[Carbon frame and chain guards](#)

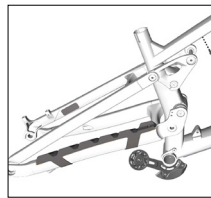

[Alloy frame and chain guards](#)

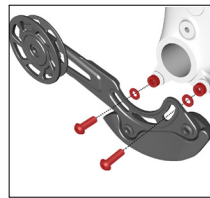

[Chain Guide](#)

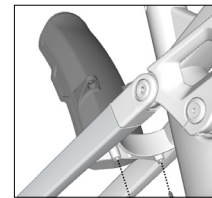

[Chain Guide](#)

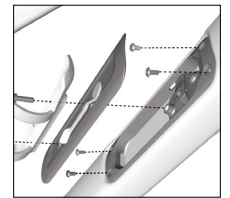

[Downtube storage](#)

Change: rear wheel headset angle progression



[Change to a 29" rear wheel](#)



[Adjust the headset angle](#)

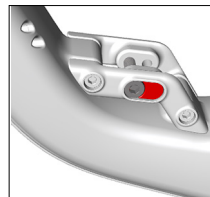

[Adjust the progression](#)

Torque order



[Torque order](#)

Specs

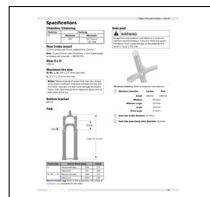

[Specifications](#)

Safety

WARNING

Properly tighten hardware

Always tighten hardware to the specified torque. Over-tightening hardware could deform or break the hardware or components. Under-tightening hardware could cause hardware or components to become loose. Either situation could damage the bicycle and result in injury to the rider.

WARNING

Reapply threadlocker

All reused-fasteners with pre-applied threadlocker must be cleaned with isopropyl alcohol and have new threadlocker applied before re-assembly. If threadlocker is not applied, the fasteners may loosen which could damage the bicycle and result in injury to the rider.

Legend



 Apply grease



Do not apply grease



 Apply threadlocker



Nm

Torque



Zip tie

Scope

This manual contains parts diagrams, specifications (such as grease and torque values), instructions, and helpful tips. It does not contain instructions for all components (such as brake calipers). Refer to the original manufacturer for more information.

Additional resources

- Bicycle Owner's Manual: trekbikes.com/manuals
- Trek's YouTube channel: youtube.com/trebikes

Adjustable headset

[See Adjust the headset angle on page 21.](#)

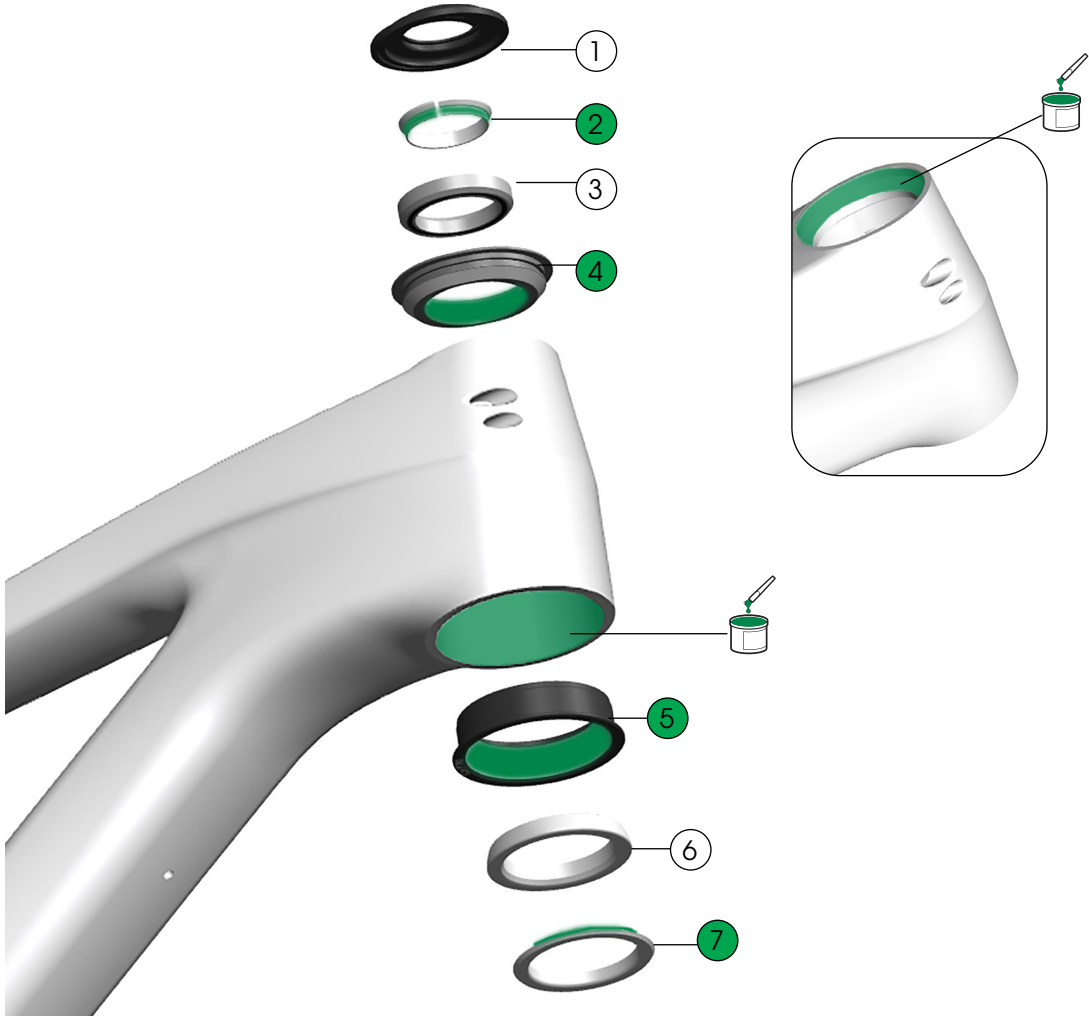

① Upper bearing cover – W5275173

② Compression ring – W532842

③ Upper bearing – W531676

④ Upper cup, 0° angle – 5304949

⑤ Press-fit lower cup, 0° angle – 5304949

⑥ Lower bearing – W532843

⑦ Crown race – W532844

W5285212

Idler pulley

NOTE: For 55mm chainlines only.

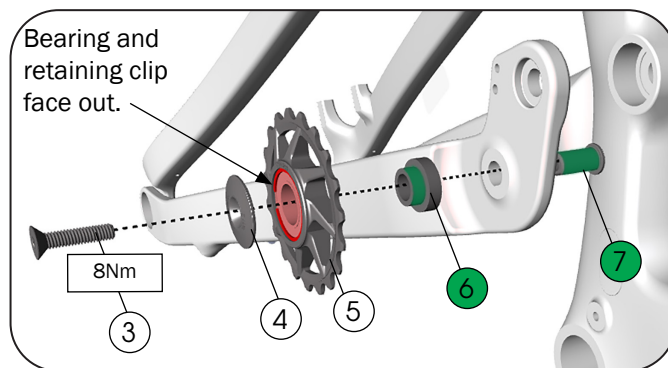
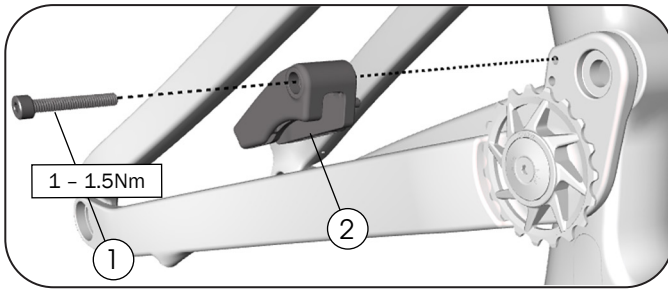

- ① Fastener, – W5271172
- ② Idler guard – W5307894
- ③ Fastener, stainless steel, M6x25mm – W5270150
- ④ Idler pulley concave washer – W5305535
- ⑤ Idler pulley assembly – W5305296
- ⑥ Idler pulley spacer – W5305382
- ⑦ Idler pulley post – W5305204

Tip: Remove the idler pulley

Remove the chain, then:

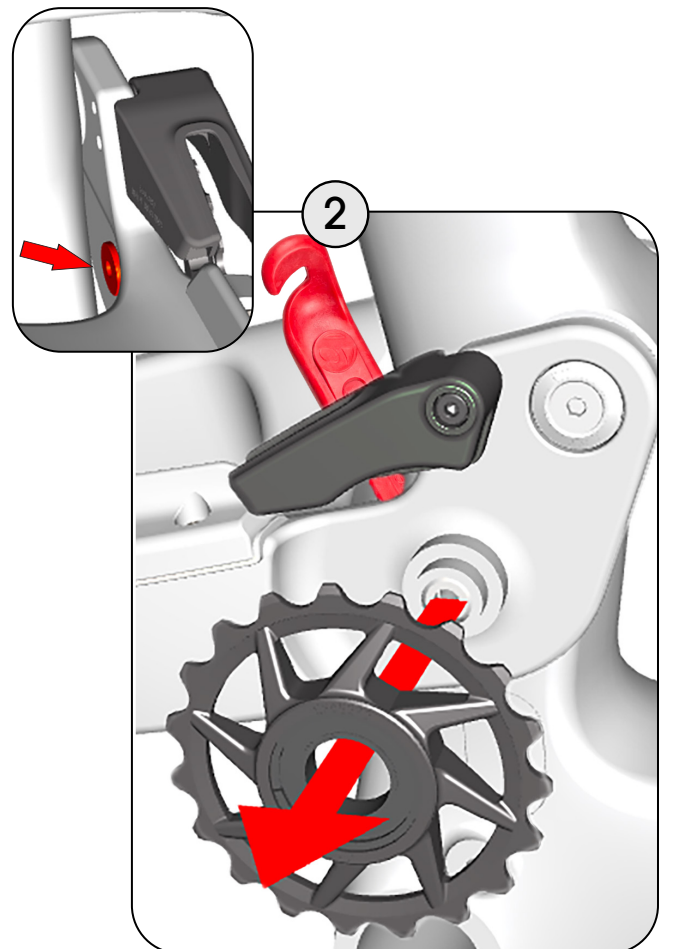
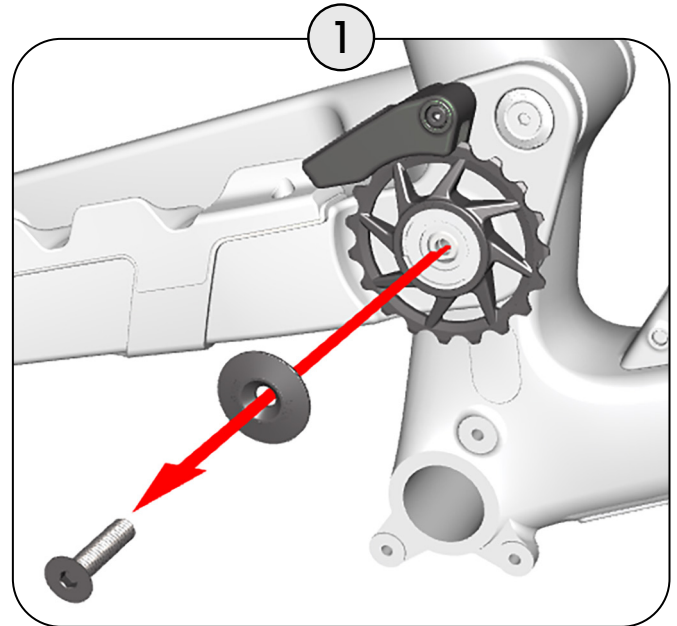

Insert a plastic pry bar behind the idler pulley post to push the idler pulley off the chainstay.

Active Braking Pivot with Universal Derailleur Hanger

Carbon frame

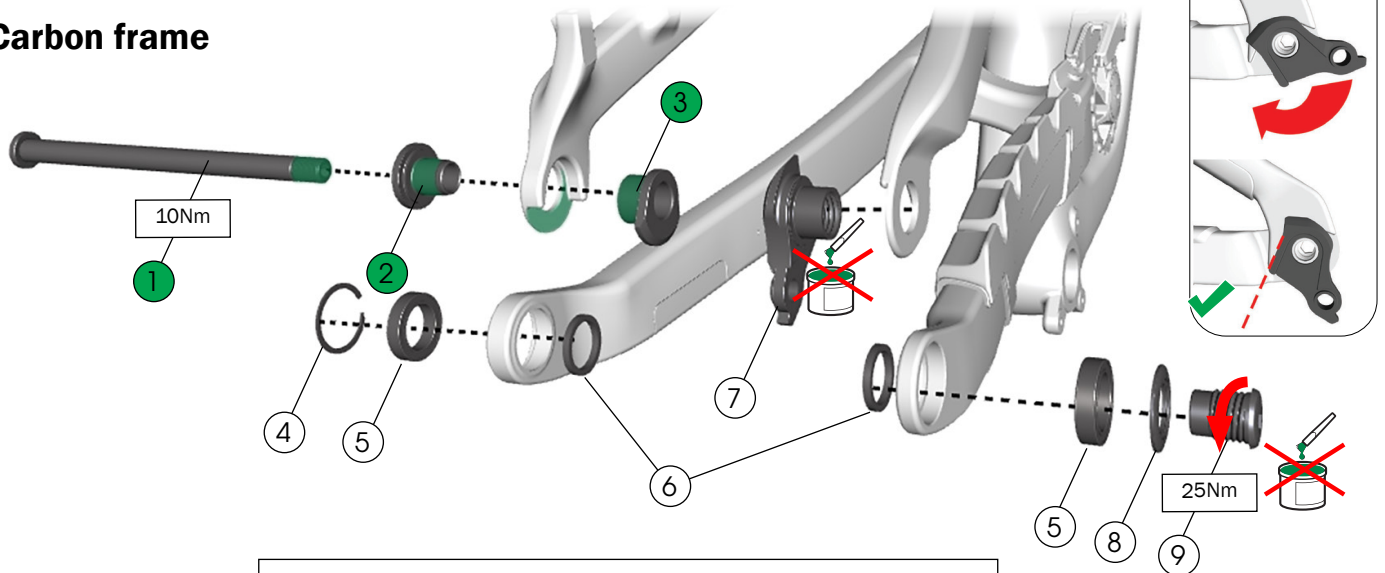

Important: The lower chainguard ([page 15](#) and [page 16](#)) must be fully installed before adjusting the derailleur.

Alloy frame

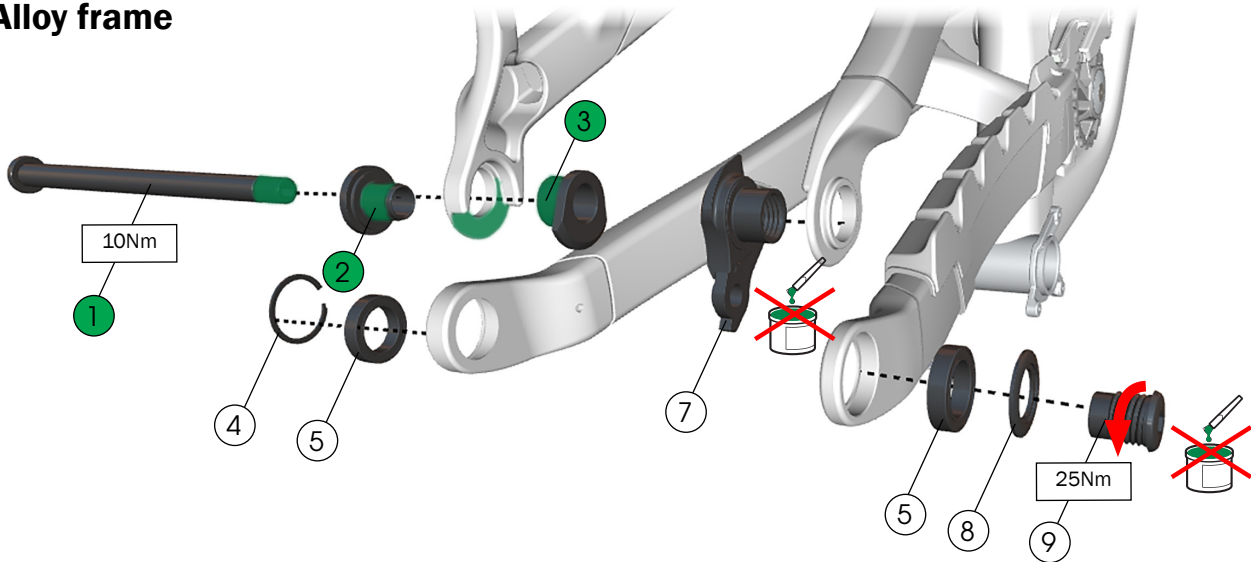

- ① Thru axle, M12x167.35mm – W583469
- ② Non-driveside ABP bolt – W5251141
- ③ Non-driveside ABP dropout nut – W5269707
- ④ Retaining ring – W5251279
- ⑤ Bearings, 20x30x7 – W5256340
- ⑥ Spacers, 25x20x3 – W583422

W5272776

- ⑦ Derailleur hanger
NOTICE: Do not apply grease.
- ⑧ Washer, 30mm
NOTICE: The washer is frame-specific. Install only the washer size specified.
- ⑨ Bolt
NOTICE: Do not apply grease. Do not overtighten. Overtightening may damage the hanger.

W5271425

Active Braking Pivot with SRAM Transmission Derailleur

Carbon frame

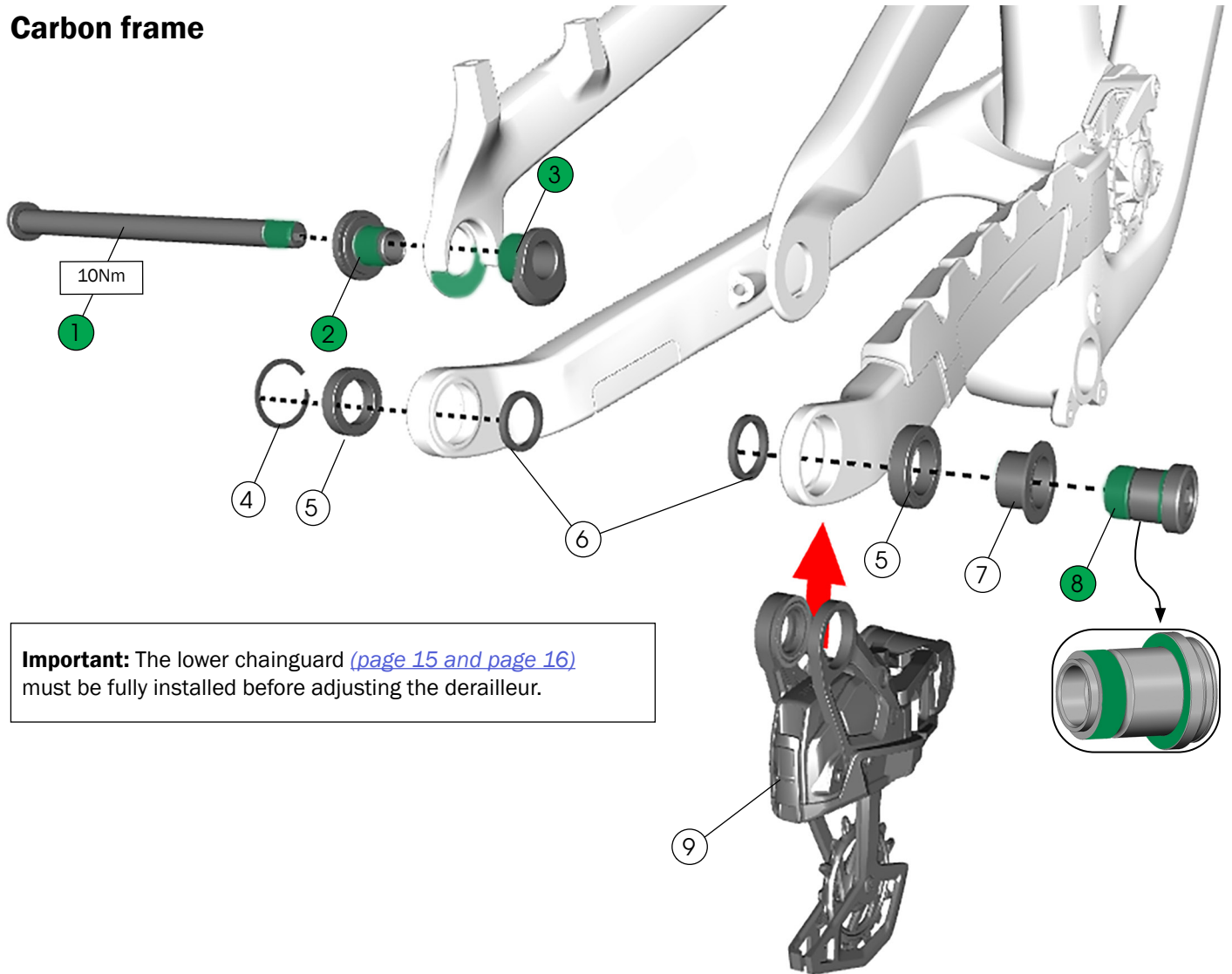

Important: The lower chainguard ([page 15](#) and [page 16](#)) must be fully installed before adjusting the derailleur.

- ① Thru axle, M12x167.35mm – W583469
 - ② Non-driveside ABP bolt – W5251141
 - ③ Non-driveside ABP dropout nut – W5269707
 - ④ Retaining ring – W5251279
 - ⑤ Bearings, 20x30x7 – W5256340
 - ⑥ Spacers, 25x20x3 – W583422
- } W5272776
- ⑦ Bushing
 - ⑧ Mounting bolt
 - ⑨ SRAM Transmission Derailleur
- } Refer to information on sram.com.

Main pivot and chainstay

See Torque order on page 10.

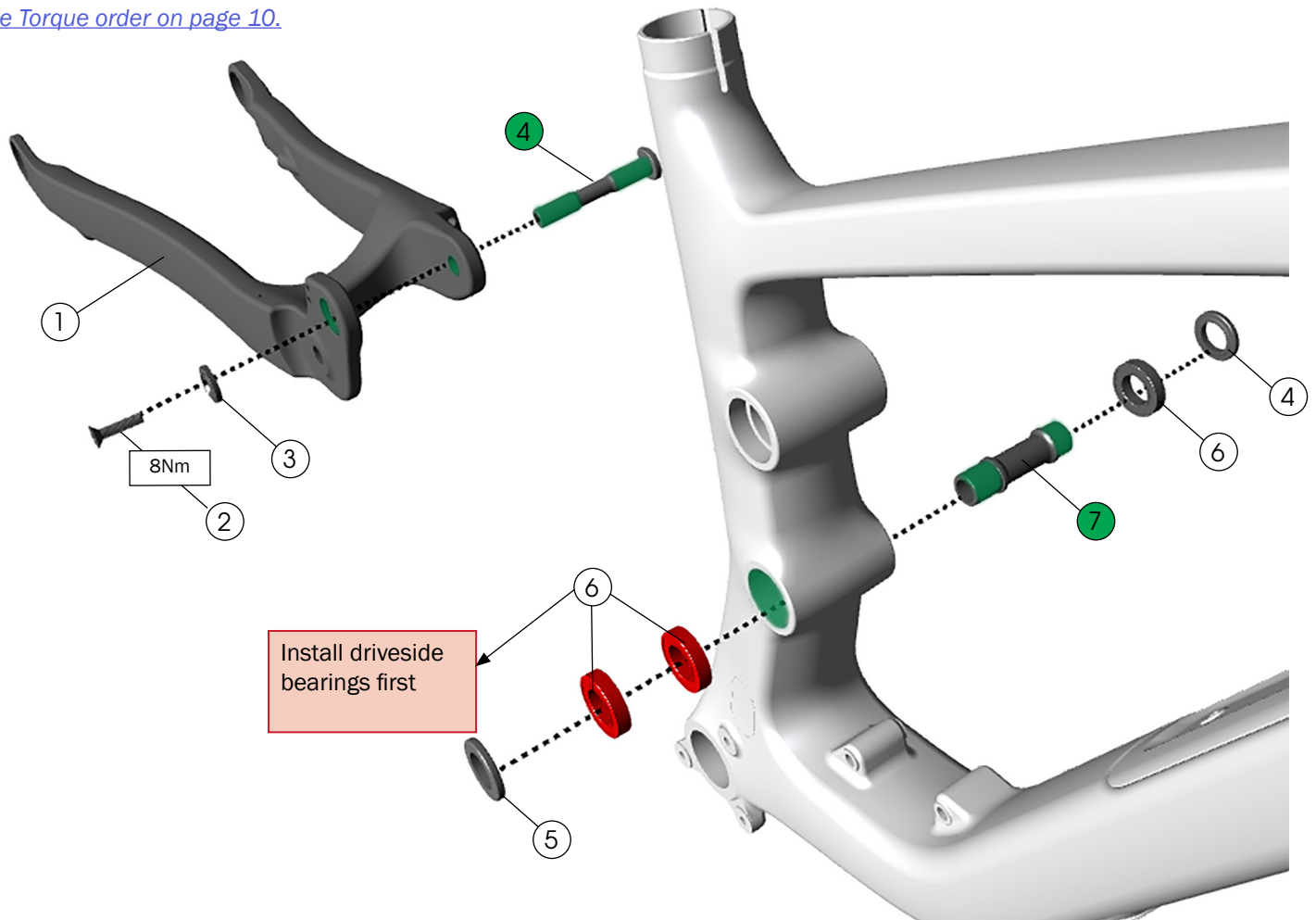

- ① **Chainstay***
Carbon – 46192
Alloy – 46193
*Paint matched part. See trekbikes.com to find the color-matched part for your bike.
- ② Fastener, M6x25mm – W5270150
- ③ Concave washer – W5270027
- ④ Thru axle, 12mmx78mm – W5305383
- ⑤ Spacers, 4mm width – W5305806
- ⑥ Bearings, 17x30x7 – 5290435
- ⑦ Flanged main pivot axle – W5305807

Rocker pivot and seatstay

See Torque order on page 10.

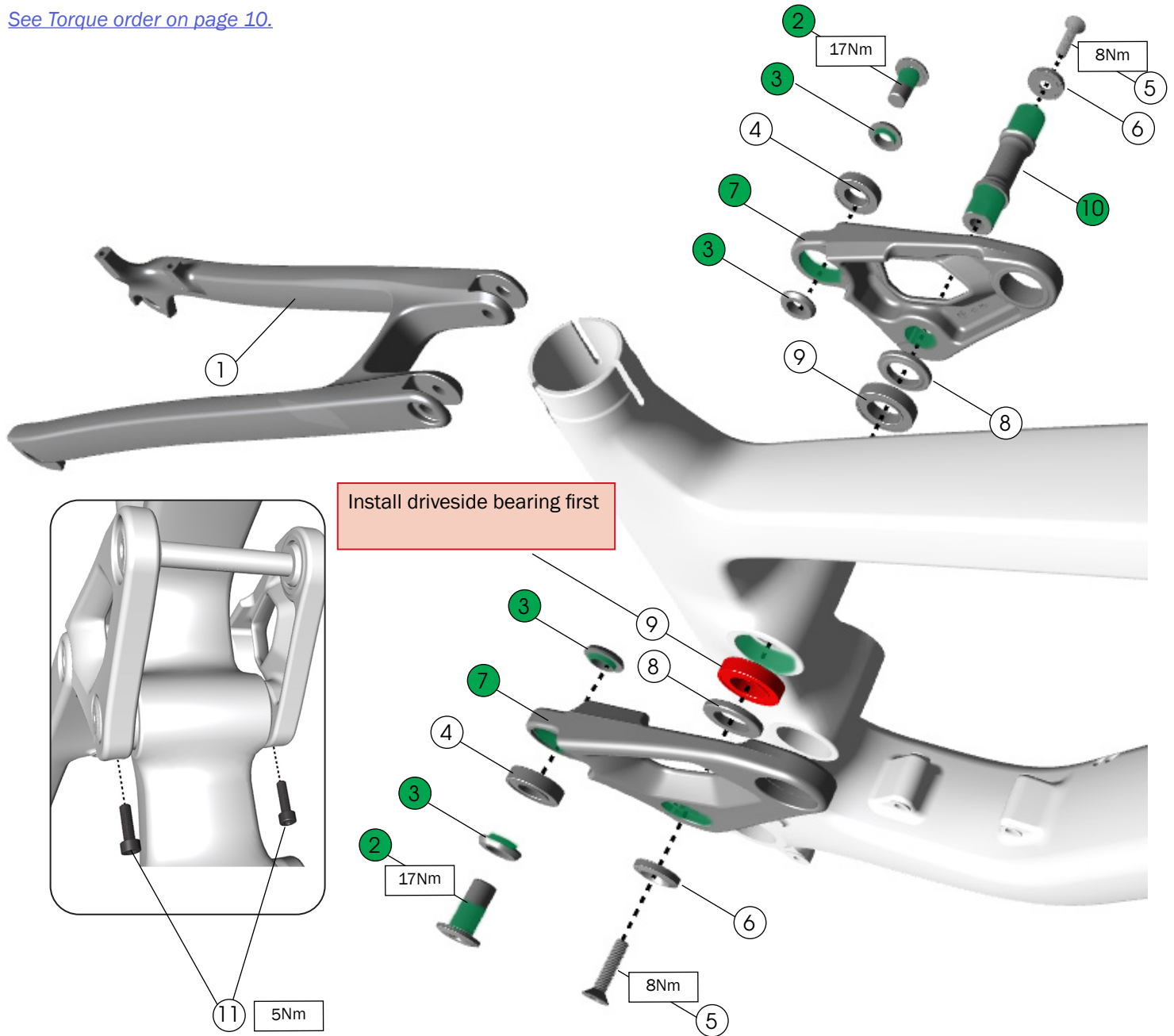

- ① **Seatstay***
Carbon – 46194
Alloy – 46195
- ② Fasteners, M10x21 – W600629
- ③ Hat-style washers – W5257190
- ④ Bearings, 12x24x6 – 5290440
- ⑤ Fasteners, M6x25 – W5270150
- ⑥ Concave washers – W5270027

- ⑦ Two-piece rocker pivot*
Carbon – 46196
Alloy – 46197
- ⑧ Spacers, 4mm wide – W5305806
- ⑨ Bearings, 17x30x7 – 5290435
- ⑩ Rocker link axle – W5305805
- ⑪ Fasteners, M5x18mm – W5256244

*Paint matched part. See trekbikes.com to find the color-matched part for your bike.

Rear shock hardware

[See Torque order on page 10.](#)

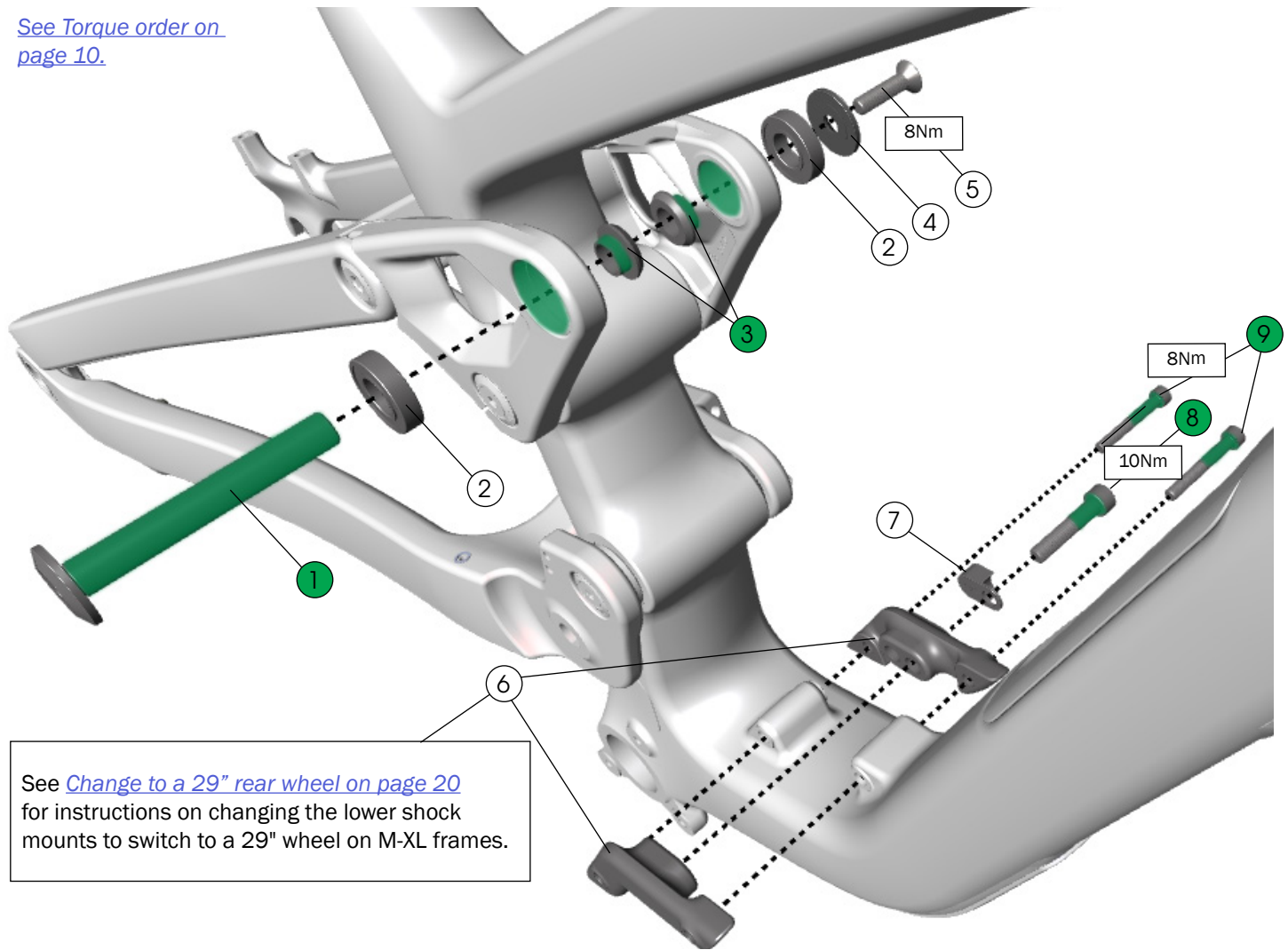

See [Change to a 29" rear wheel on page 20](#) for instructions on changing the lower shock mounts to switch to a 29" wheel on M-XL frames.

- ① Upper shock mount axle, M6x67 – W5305189
- ② Bearings, 12x24x6 – 5290440
- ③ Hat-style washers – W5257189
- ④ Concave washer – W5305190
- ⑤ Fastener, M6x25 – W5270150
- ⑥ **Lower shock mounts for use with:**
 Size S, 27.5" rear wheel
 or
 Size M - XL, 29" after-market rear wheel
 Size M - XL, 27.5" rear wheel – 5317349
 } 5317350
- ⑦ Progression mino link – 5303333
Includes a More/Less nut that is not used on the Slash.
- ⑧ Fastener, M8x40mm – W5305730
- ⑨ Fasteners, M6x40mm – W5305731



Shock Dimensions

- Eye-to Eye-length: 230mm
- Stroke length: 65mm
- Shock air can mount/bolt: 54mmx10mm
- Shock shaft mount/bolt: 20mmx8mm

For a list of compatible shocks, refer to the FAQ on the Gen 6 Slash product pages on trekbikes.com.

Torque order

Important: Remove the bike from the bike stand and set it on the ground before torquing all fasteners to spec.

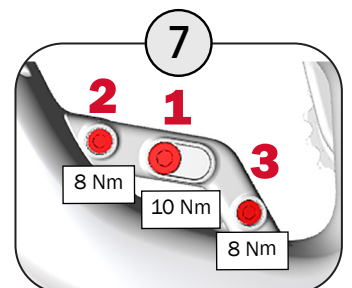
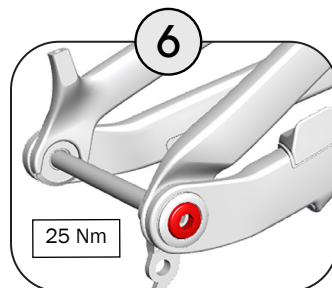
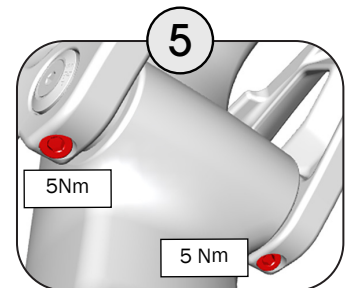
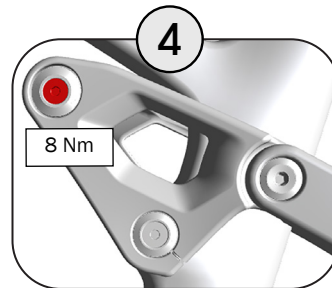
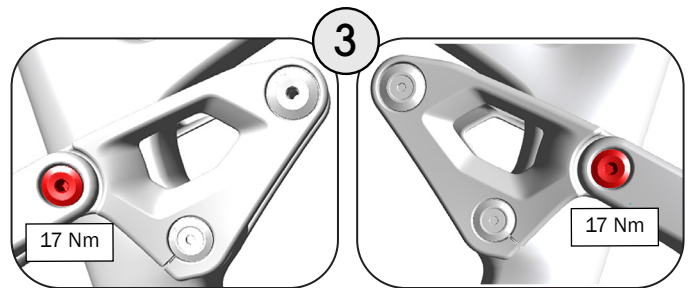
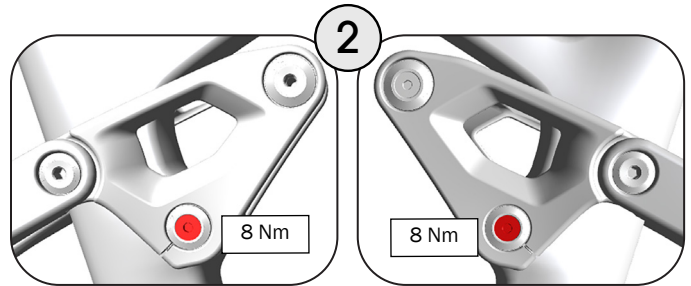
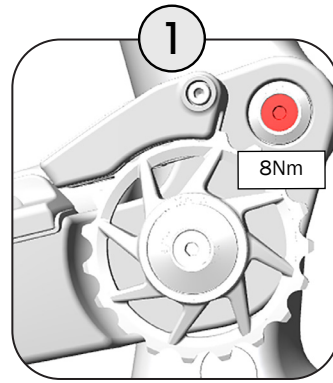

Carbon routing with mechanical shift

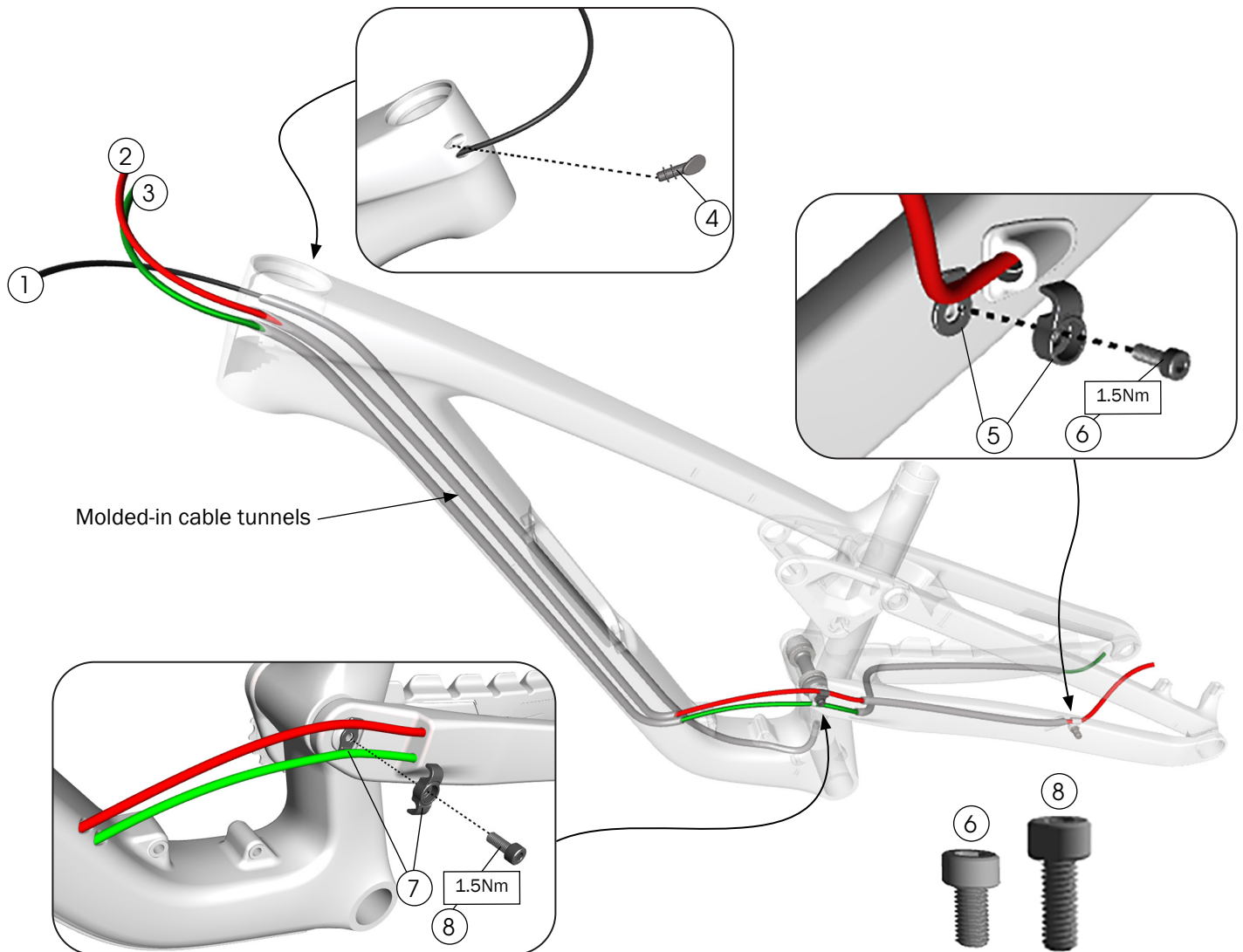

- ① Seatpost dropper cable housing
- ② Rear brake hose
- ③ Shift cable housing
- ④ Frame plug, 7mm – W5309145
- ⑤ Bolt-on cable guide, single – W311727*
- ⑥ Fastener, M5x8mm – W596823
- ⑦ Bolt-on cable guide, double – W311726*
- ⑧ Fastener, M5x10mm – W5252771

***NOTICE:** The fastener included with the cable guide is too long. Do not use it. Use the fastener shown above.

Carbon routing with AXS shift

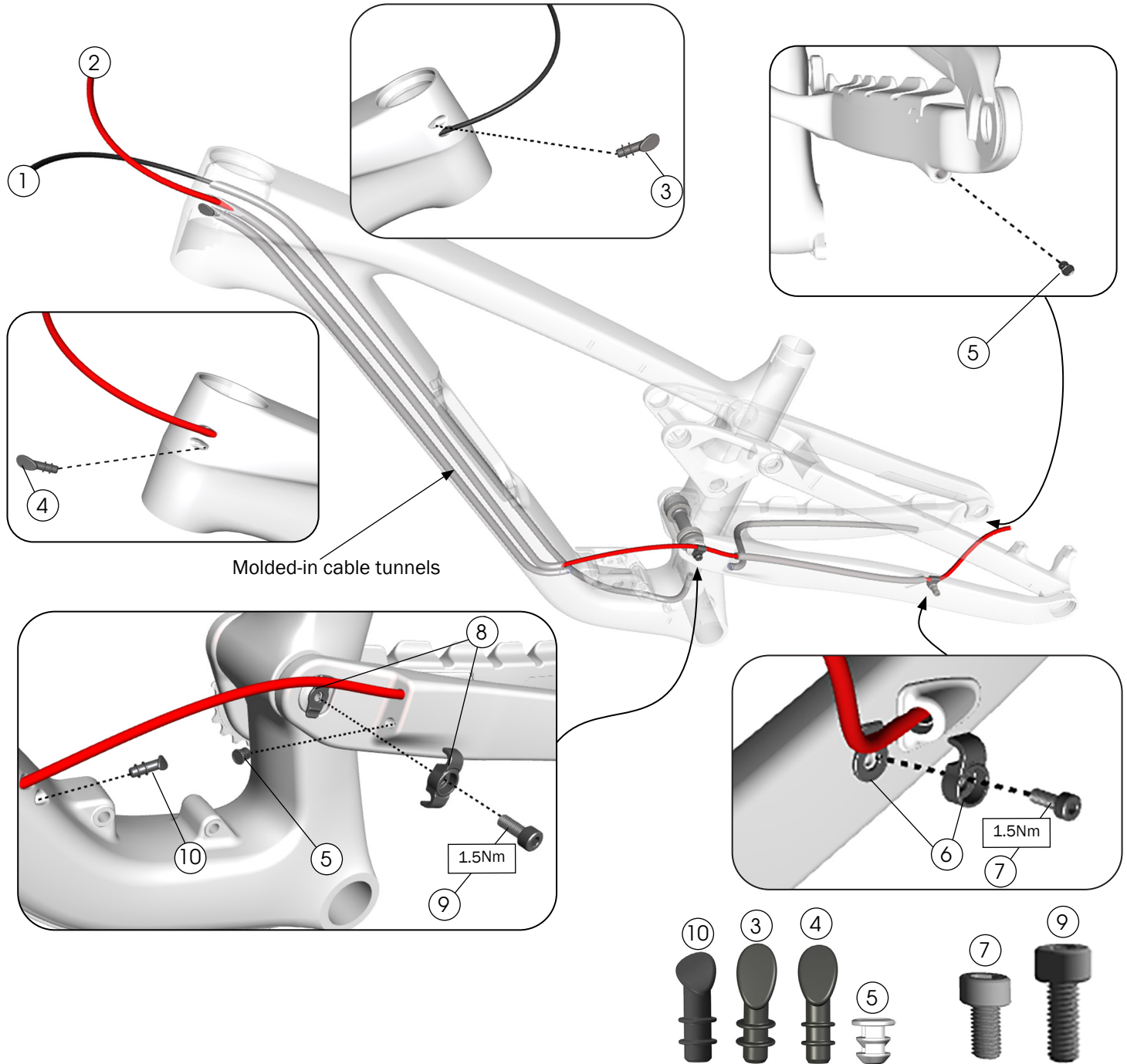

- ① Seatpost dropper cable housing
- ② Rear brake hose
- ③ Frame plug, 7mm – W5309145
- ④ Frame plug, 6mm – W5309144
- ⑤ Cable exit plug, 5.5mm – W600209
- ⑥ Bolt-on cable guide, single – W311727*

- ⑦ Fastener, M5x8mm – W596823
- ⑧ Bolt-on cable guide, double – W311726*
- ⑨ Fastener, M5x10mm – W5252771
- ⑩ Frame plug – W5309146

***NOTICE:** The fastener included with the cable guide is too long. Do not use it. Use the fastener shown above.

Alloy routing with mechanical shift

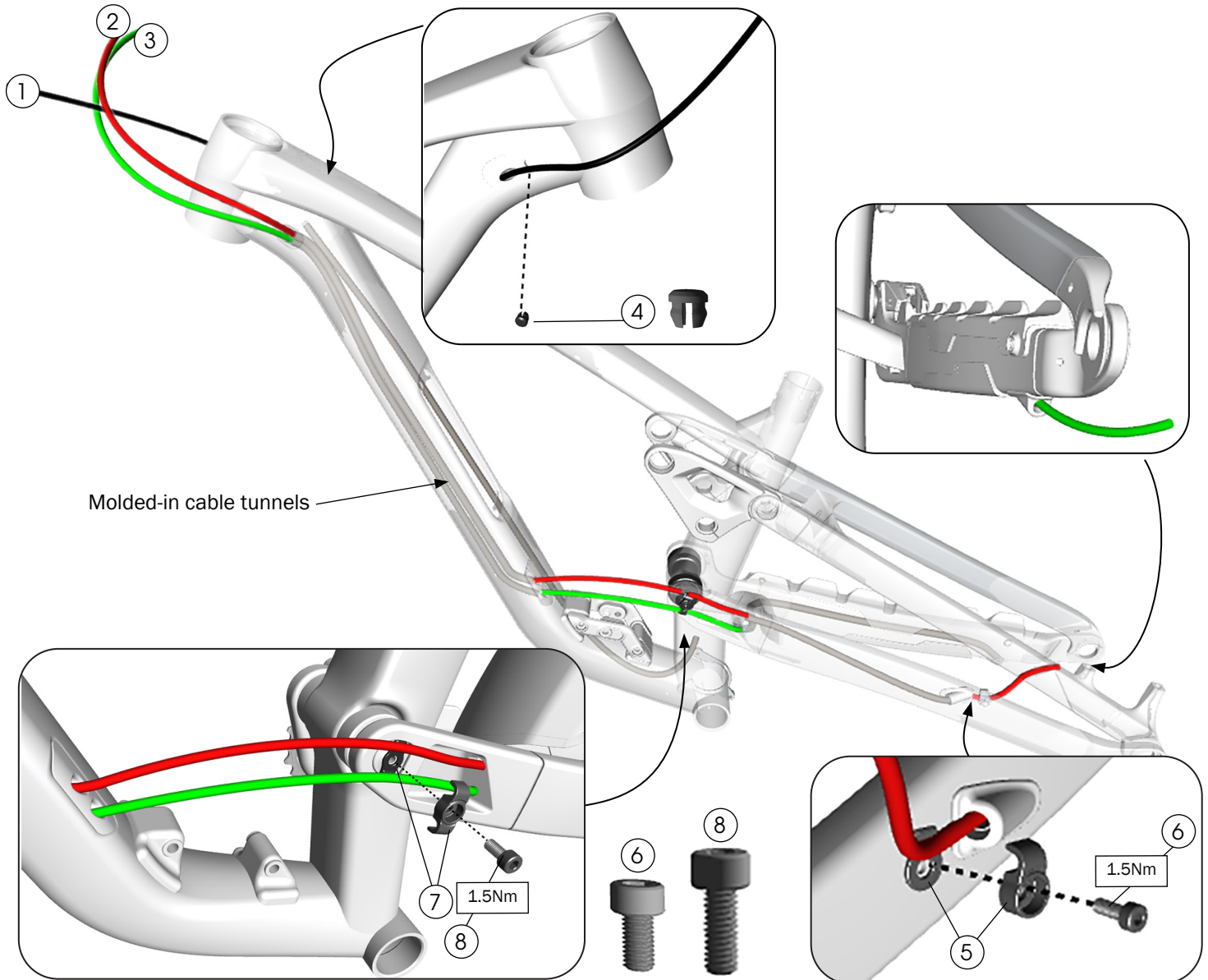

- ① Seatpost dropper cable housing
- ② Rear brake hose
- ③ Shift cable housing
- ④ Frame plug – W5275264
- ⑤ Bolt-on cable guide, single – W311727*
- ⑥ Fastener, M5x8mm – W596823
- ⑦ Bolt-on cable guide, double – W311726*
- ⑧ Fastener, M5x10mm – W5252771

***NOTICE:** The fastener included with the cable guide is too long. Do not use it. Use the fastener shown above.

Alloy routing with AXS shift

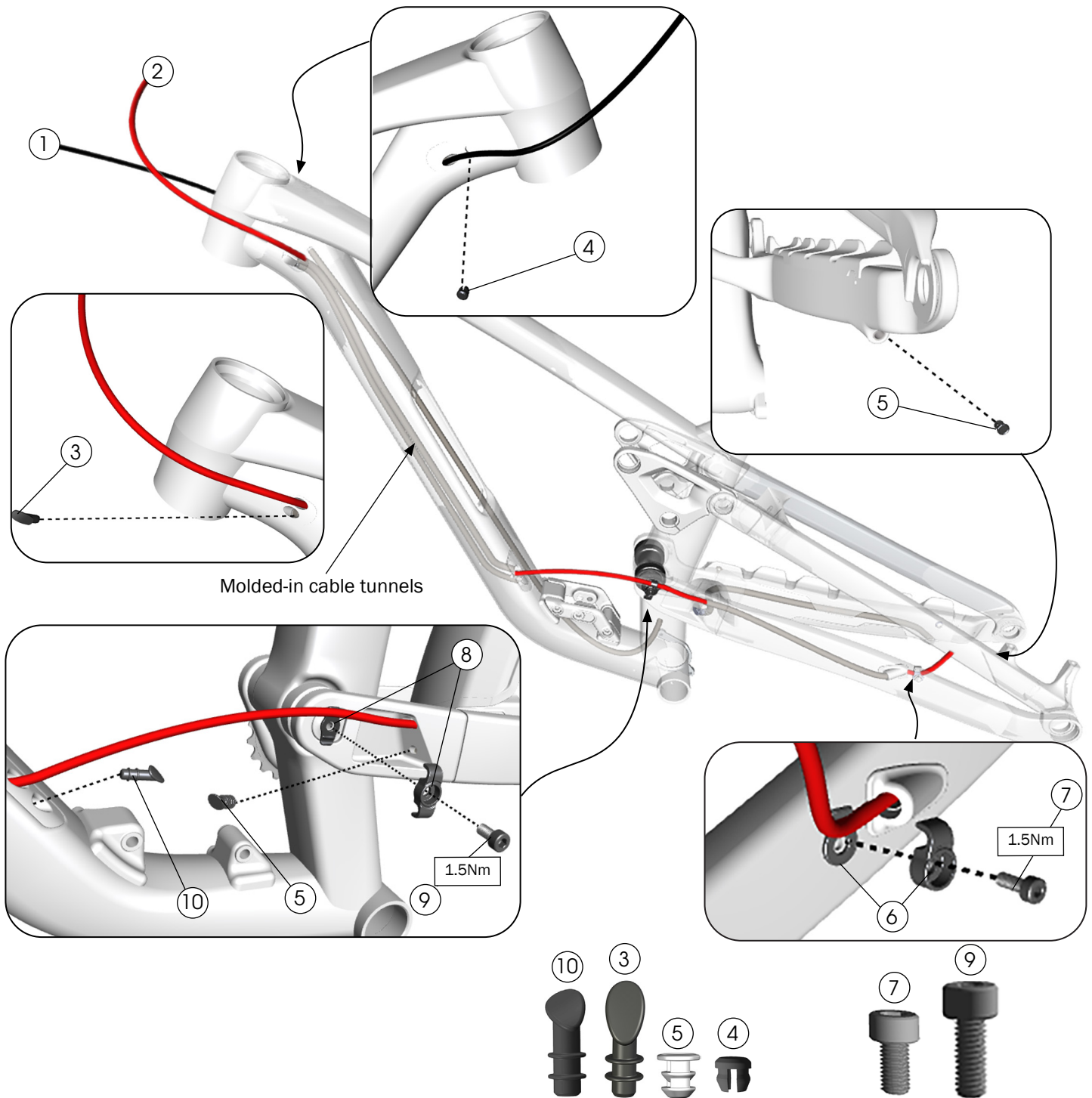

Molded-in cable tunnels

1.5Nm

1.5Nm

① Seatpost dropper cable housing

② Rear brake hose

③ Frame plug, 6mm – W5309144

④ Frame plug – W5275264

⑤ Frame plug, 5.5mm – W600209

⑥ Bolt-on cable guides, single – W311727*

⑦ Fastener, M5x8mm – W596823

⑧ Bolt-on cable guide, double – W311726*

⑨ Fastener, M5x10mm – W5252771

⑩ Frame plug – W5309845

***NOTICE:** The fastener included with the cable guide is too long. Do not use it. Use the fastener shown above.

Carbon frame and chain guards

Bonded strike guards ② ③

1. To improve adhesion, use sandpaper to roughen the backside of the guards and/or remove remnants of the old guard from the areas of the frame where epoxy will be applied.
2. Attach the guards with a two-part epoxy.
3. Allow the guards and epoxy to cure for 24 hours.

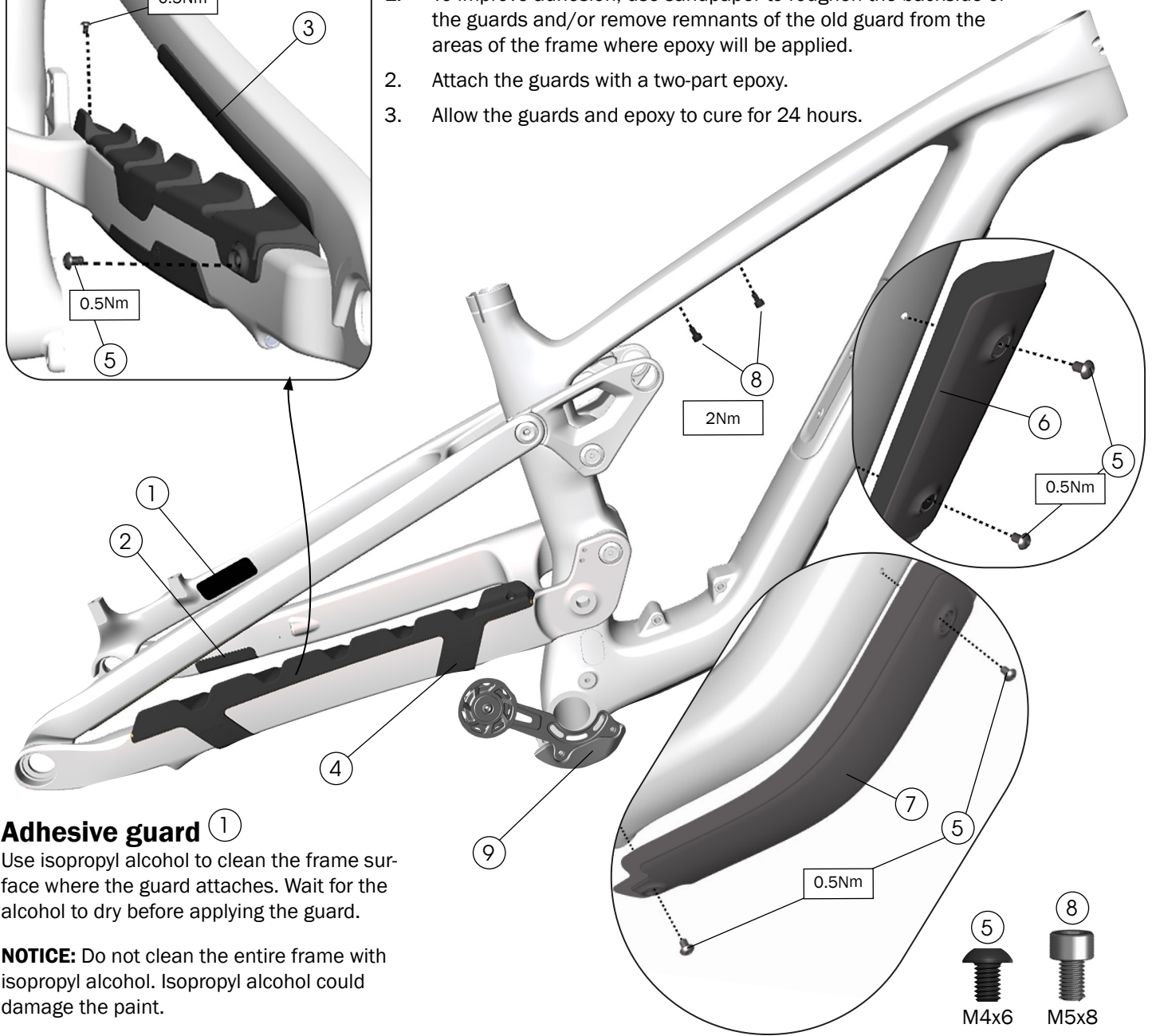
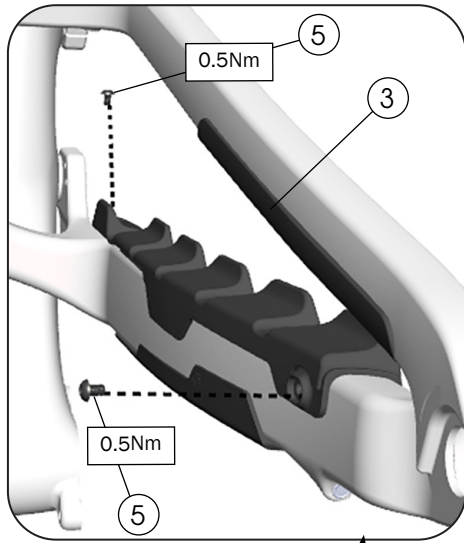

Adhesive guard ①

Use isopropyl alcohol to clean the frame surface where the guard attaches. Wait for the alcohol to dry before applying the guard.

NOTICE: Do not clean the entire frame with isopropyl alcohol. Isopropyl alcohol could damage the paint.

① Adhesive guard – W326986

② Rotor guard – W580881

③ Seatstay guard – W5255862

④ Chainstay guard – W5306300

⑤ Fastener, M4x6mm – W575056

⑥ Shuttle guard – W5306877

⑦ Downtube guard
S/M – W5306634
ML/L – W5307353
XL – W5307890

⑧ Fasteners, M5x8mm – W596823

⑨ MRP MXg Chain guide – W5311741
Important: Fully install before adjusting the derailleur. [See Chain Guide on page 17.](#)



Alloy frame and chain guards

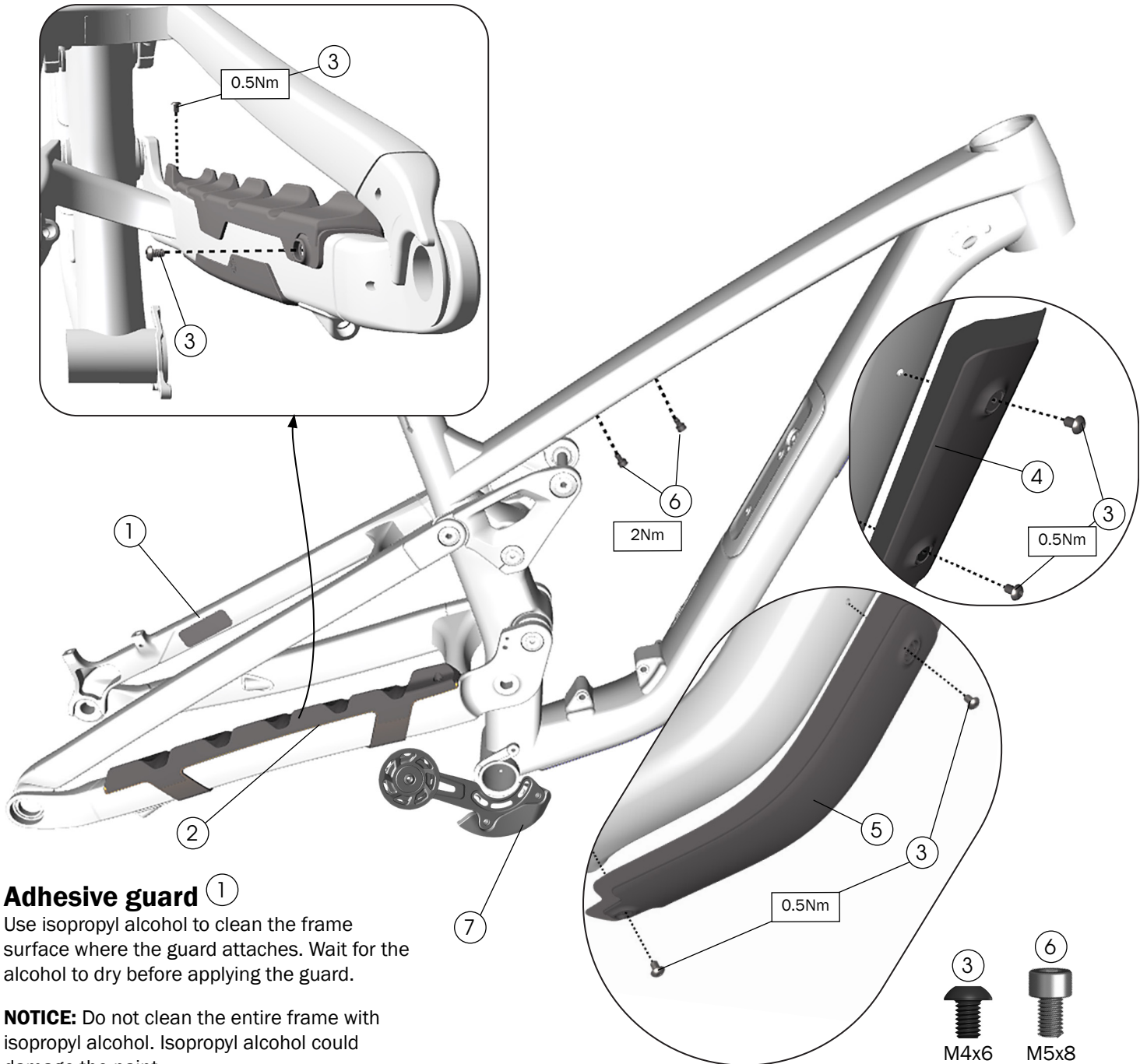

Adhesive guard ①

Use isopropyl alcohol to clean the frame surface where the guard attaches. Wait for the alcohol to dry before applying the guard.

NOTICE: Do not clean the entire frame with isopropyl alcohol. Isopropyl alcohol could damage the paint.

- ① Adhesive guard – W326986
- ② Chainstay guard – W5306300
- ③ Fastener, M4x6mm – W575056
- ④ Shuttle guard – W5306877

- ⑤ Downtube guard
S/ML – W5307891
L/XL – W5307893
- ⑥ Fasteners, M5x8mm – W596823
- ⑦ MRP MXg Chain guide – W5311741
Important: Fully install before adjusting the derailleur. [See Chain Guide on page 17.](#)

Chain Guide

1 Install the correct number of spacers.

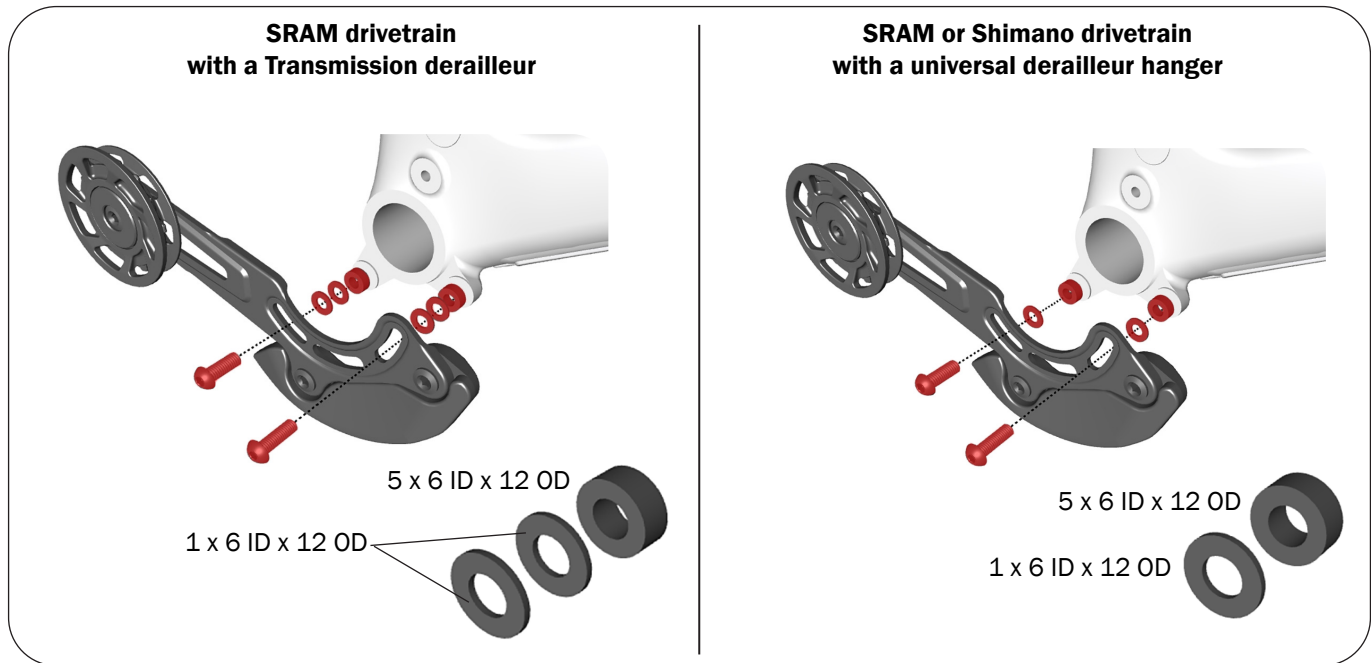

2 Position the chain guide 32mm below the chainstay guard.

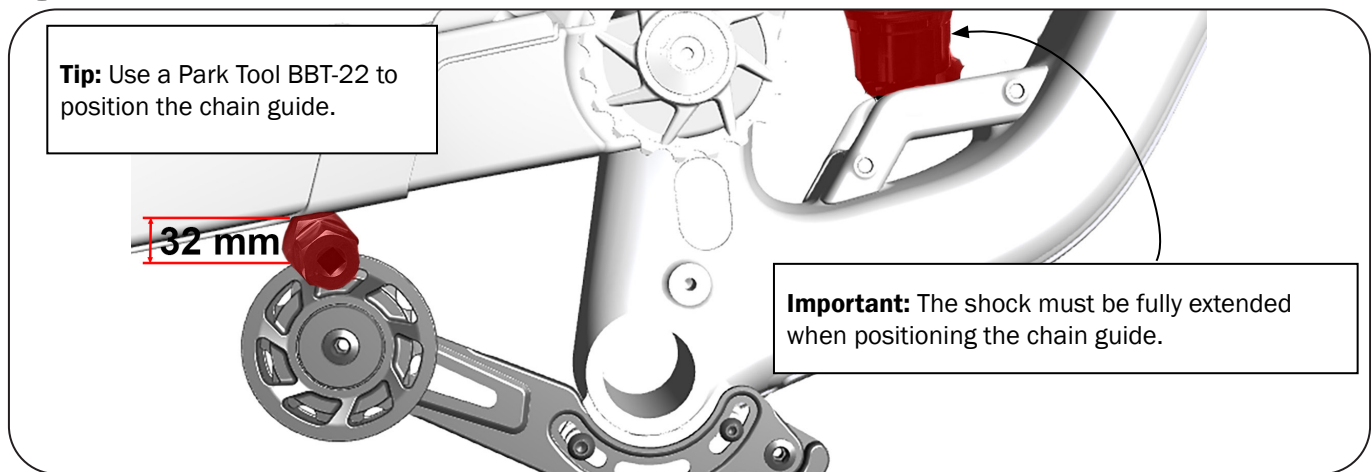

3 Use a caliper tool to confirm the position.

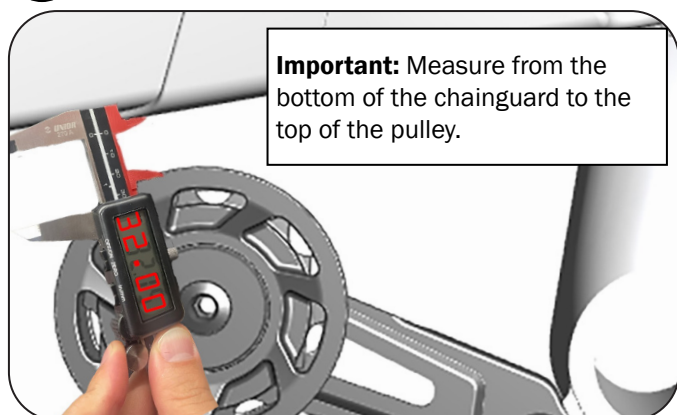

4 Torque the chain guide fasteners.

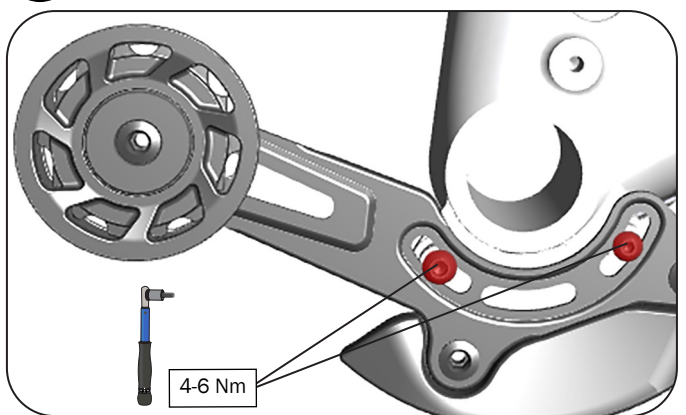

Rear fender

Important: The rear fender is only compatible with a 27.5" wheel.

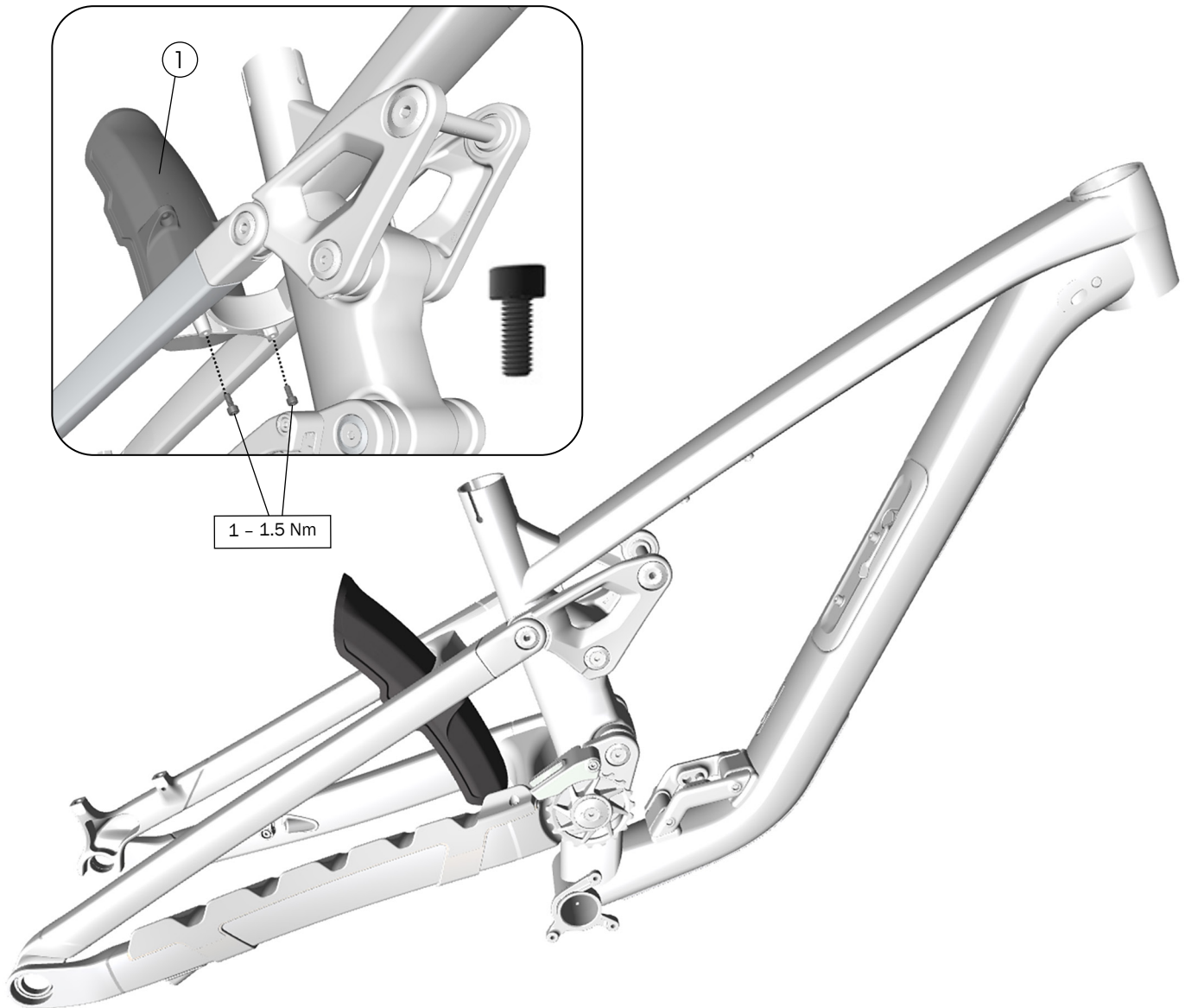

① Fender and fasteners (M4x10mm) – W5308789

Downtube storage

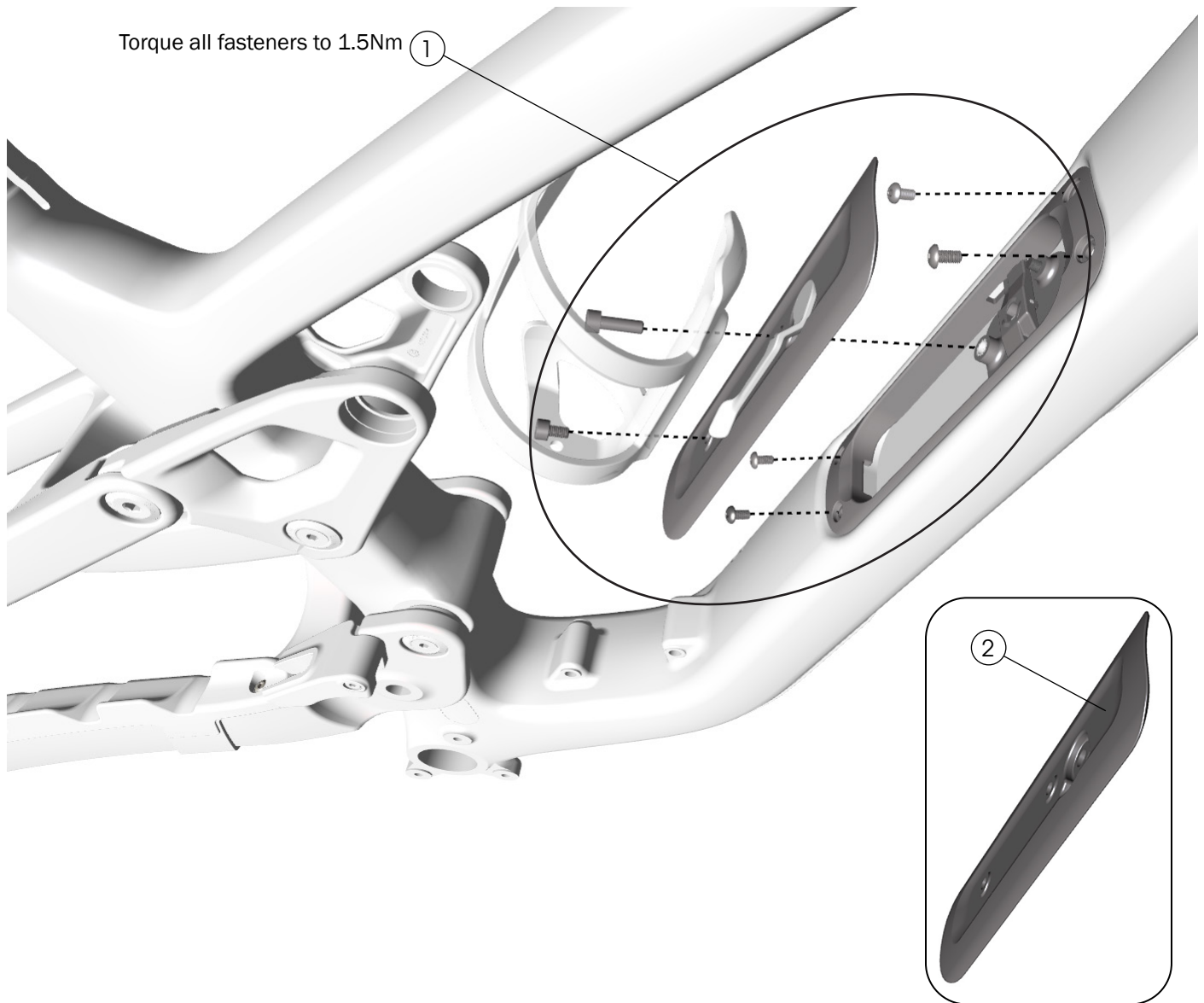

① Downtube storage assembly with matte black door – W5297657

② Paint-matched storage door only – 46198 and 46199.
See both part numbers on trekbikes.com to see all color options.

Important: Also order ① to receive the fasteners, lever and base.

Change to a 29" rear wheel

Size M-XL: To change to a 29" rear wheel, remove the 27.5" lower shock mounts and replace them with the 29" lower shock mounts.

Size S: Is not compatible with a 29" rear wheel. Small frames use the same lower shock mounts as a 29" rear wheel, but 29" wheels do not fit on the small frames.

Lower shock mounts for 29" rear wheel

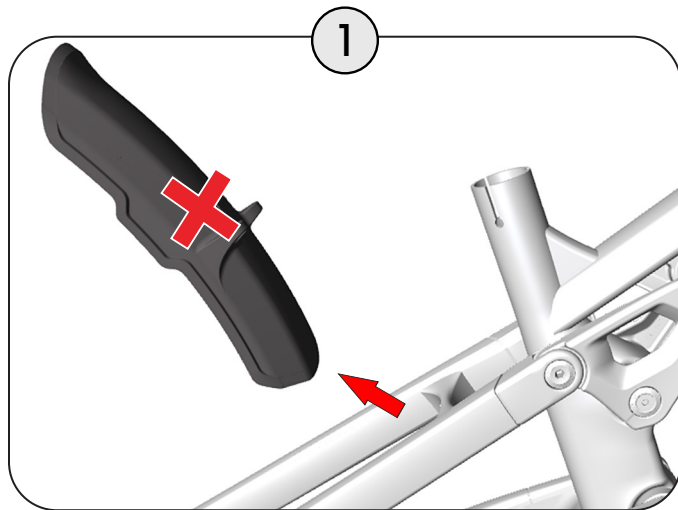
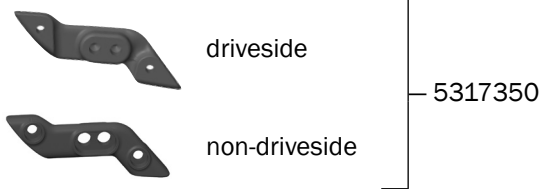

Remove the rear wheel. This will make it easier to manipulate the swingarm when aligning the shock and lower mounts in step 3.

Remove the rear fender. It's not compatible with a 29" wheel.

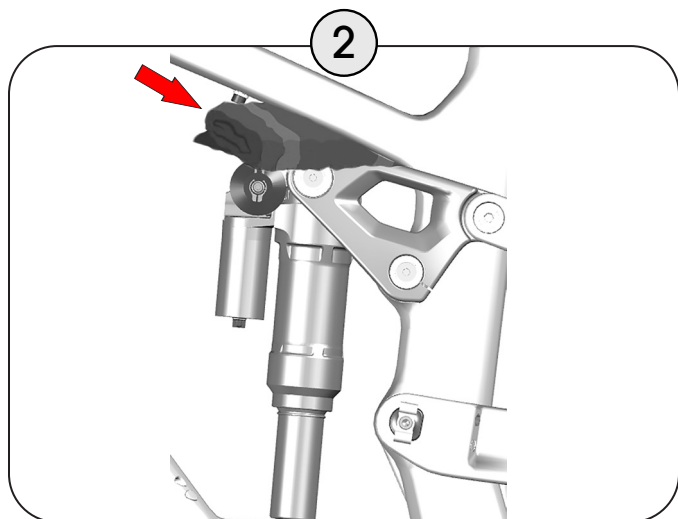

Place a clean shop rag between the shock and the frame to protect the frame.

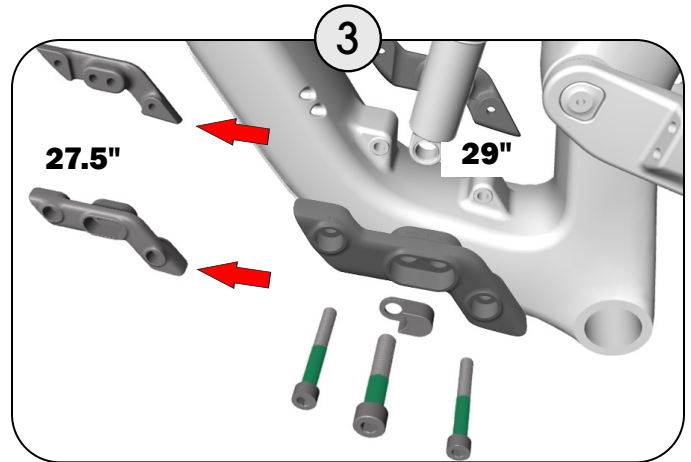

Remove the 27.5" lower shock bolt, lower shock mounts and the mino link. Re-insert the mino link into the 29" lower shock mount. Install the 29" lower shock mounts and shock bolt. Loosely tighten, but do not torque the bolts.

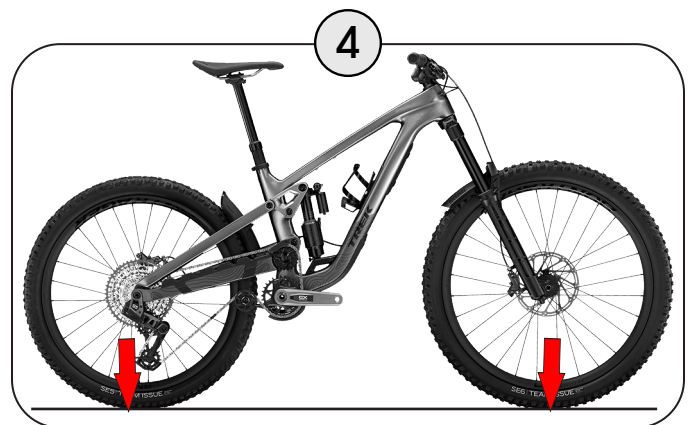

Important: Before torquing the shock mount bolts:

- Re-install the rear wheel
- Remove the bike from the stand and set the wheels on the ground. The weight of the bike will help align the shock and lower shock mounts for proper torque.

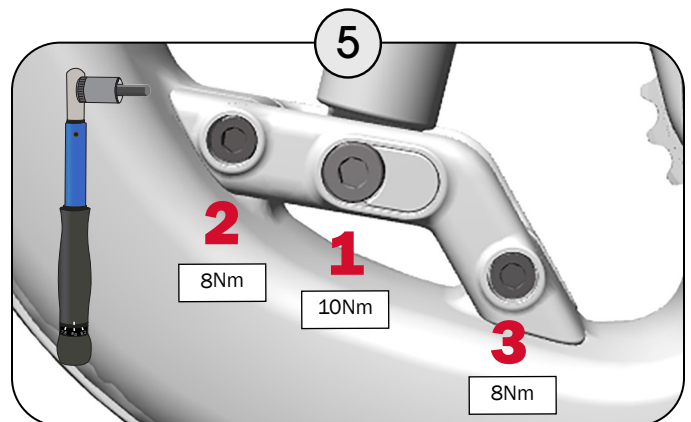

Torque the shock bolt and then the lower shock mounts.

Adjust the headset angle

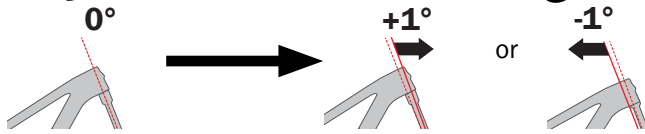

Tools

- Upper angled cup:
S – ML frames – W5295319
L – XL frames – W5295274
- Lower angled cup – W5294449
- Adjustable headset alignment tool – 5310000
- Headset cup removal tool
- 8mm hex tool (150mm minimum length for XL frame)
- Headset cup press
- Painter's tape
- Grease

Remove components

1. Remove the fork.
2. Remove the upper headset assembly.
3. Use the headset cup removal tool to remove the lower headset cup.

Install the alignment tool

1. Use the alignment tool to mark the centerline to which you will align the lower cup.

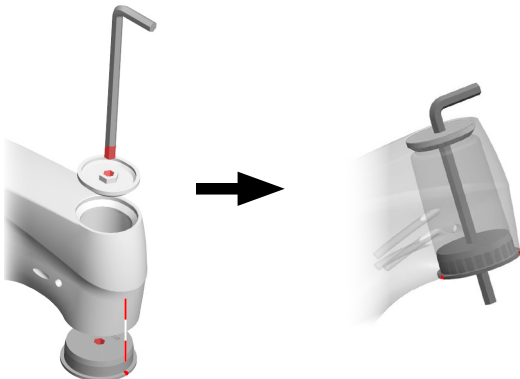

2. Thread the hex tool through the upper alignment tool. Insert the tools into the upper head tube.
3. Position the lower alignment tool with the notches to the front and back of the head tube.
4. Thread the lower alignment tool over the hex tool. The hex tool will keep the notches aligned as you insert the alignment tool.
5. Place a piece of painter's tape on the head tube, then draw a line on the tape that aligns with the notch.

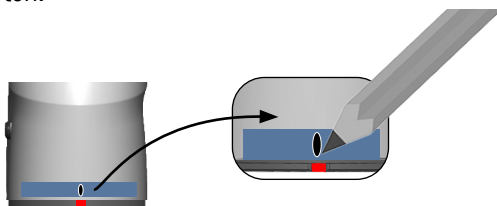

6. Remove both pieces of the alignment tool.

Install the angled cups

1. Grease the cups and head tube bores.

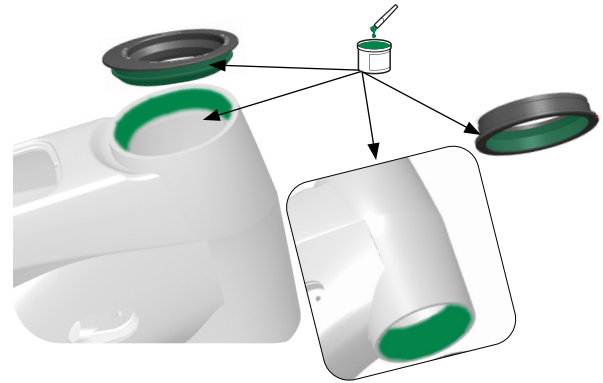

2. Position the upper cup and insert it into the head tube.



3. Position the lower cup to match the angle of the upper cup.



4. Align the notch on the cup with the line on the painter's tape.
5. Press in the lower cup. **Note:** position the press with the handle above the head tube.

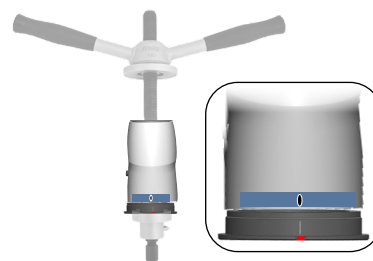

6. Remove the press. Verify the notch on the lower cup is aligned with the line on the tape. If it is not, remove cup and reinstall in correct position.
7. Remove the painter's tape.

Adjust the progression

The shock progression chip can be flipped to fine tune the shock performance for the terrain or rider preference.

20% Progression Softer

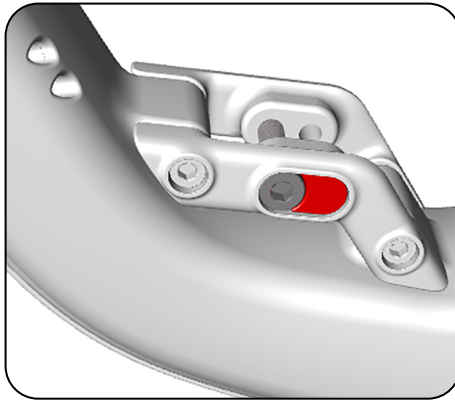

More reactive to repeated fast mid-size bumps and square-edge hits

25% Progression Firmer

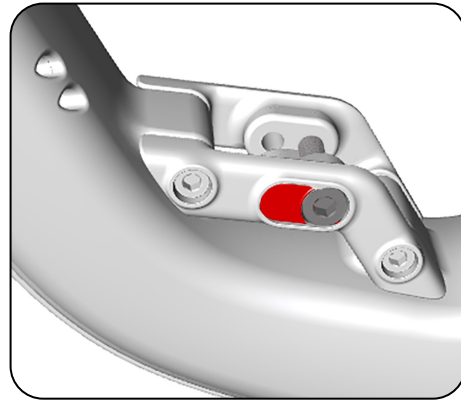

More bottom-out resistance over big hits and drops

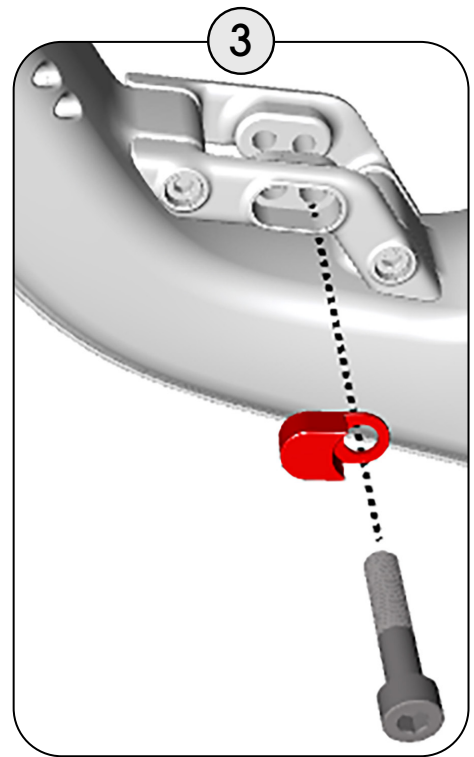
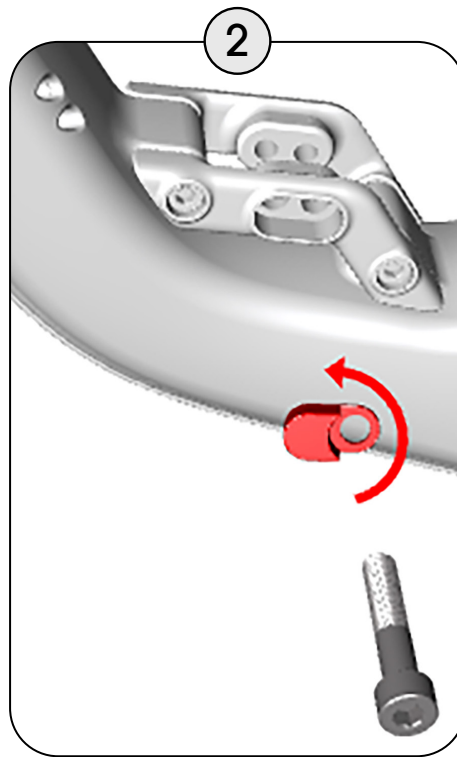
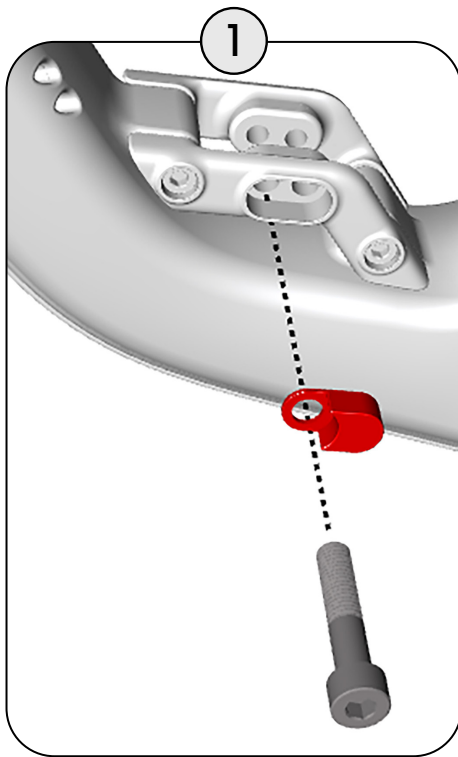
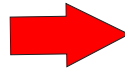

Specifications

Chainline/Chainring

Chainline	Chainring	
	Minimum	Maximum
55	28T	34T round 32T oval

Rear brake mount

200mm direct post mount, adaptable to 220mm

NOTICE: To use a 203mm rotor, RockShox 1.5mm brake adapter spacers are required. – W5252574

Rear O.L.D

148mm

Maximum tire size

M, ML, L, XL: 29" x 2.5" (front and rear)

S: 27.5" x 2.5" (front and rear)

Notice: Measurements of actual tires may vary. Always verify there is sufficient clearance between the tire and the frame. Improper tire size could damage the bicycle frame. Trek recommends 6mm clearance above and on both sides of the tire.

Bottom bracket

BSA73

Fork

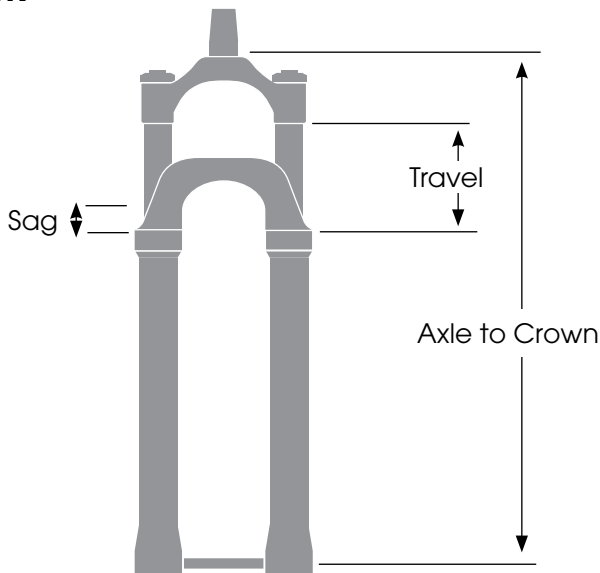

Frame size	Axle to Race (mm)		Travel
S	Recommended	566	170
	Maximum	587	190
M, ML, L, XL	Recommended	586	170
	Maximum	606	190

Recommended sag: Refer to the suspension calculator at Trekbikes.com/suspension-calculator.

Seat post

WARNING

Always follow the seatpost manufacturer's minimum insertion recommendation. Failure to follow the recommendation could cause damage to the seatpost and result in injury to the rider.

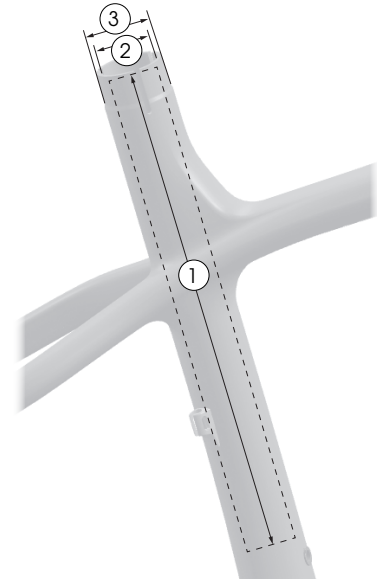

Minimum insertion: Refer to seatpost manufacturer.

① Maximum insertion	Carbon	Alloy
Small:	290mm	295mm
Medium:	305mm	
Medium/Large:	325mm	
Large:	340mm	
Extra large:	370mm	
② Seat tube inside diameter:	34.9mm	
③ Seat tube post-clamp outer diameter:	39.5mm	